

REV.	DATE	DESCRIPTION
NC	04/06/03	INITIAL RELEASE

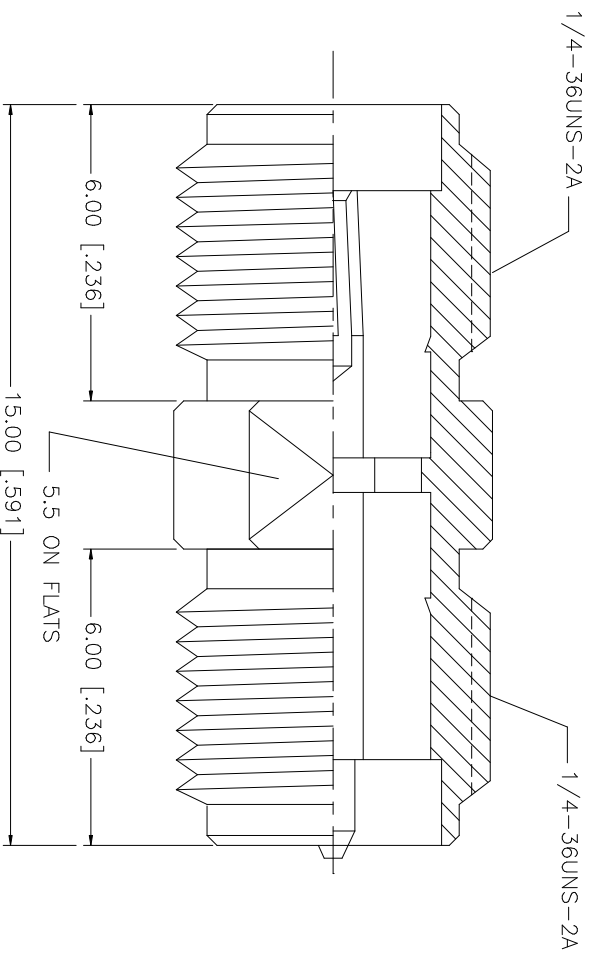

QTY	FINISH	MATERIAL	DESCRIPTION
1	GOLD	BER. COPPER	CONTACT PIN
1	NATURAL	TEFLON	INSULATOR
1	GOLD	BRASS	HOUSING/BODY
			DESCRIPTION

UNLESS OTHERWISE SPECIFIED DIMENSIONS ARE IN MILLIMETERS. DIMENSIONS IN [] ARE IN INCHES AND FOR CUSTOMER REFERENCE ONLY. TOLERANCES FOR MILLIMETERS ARE:	APPROVALS	DATE
0.5 - 8mm ± 0.20mm	DRAWN G.R.S.	04/06/03
8 - 30mm ± 0.40mm	CHECKED	
30 - 120mm ± 0.50mm	ISSUED	
UNLESS OTHERWISE SPECIFIED DIMENSIONS ARE IN MILLIMETERS. DIMENSIONS IN [] ARE IN INCHES AND FOR CUSTOMER REFERENCE ONLY. TOLERANCES FOR INCHES ARE:	SHEET 1 OF 1	
.020 - .315 = ± 0.007"	CAD FILE C:/132/132169RP.DWG	
.315 - 1.180 = ± 0.015"	DWG. NO. 132169RP.DWG	
1.180 - 4.724 = ± 0.020"	REV. NC	
	SIZE A	
	SCALE NA	

PART DESCRIPTION	
SMA JACK TO REVERSE POLARITY JACK ADAPTER	132169RP

Amphenol Connex

SMA JACK TO REVERSE POLARITY JACK ADAPTER

132169RP